

**EAST 175<sup>TH</sup> STREET (60' WIDE)**

**275.00'**

**CENTER LINE OF BLOCK  
PARALLEL WITH TOPPING AVENUE**

FENCE CONC 2.01'E  
**20.00'** YARD

**PARALLEL WITH EAST 175<sup>TH</sup> STREET  
95.00'**

**PARALLEL WITH EAST 175<sup>TH</sup> STREET  
95.00'**

**TAX LOT 17  
AREA = 1,900.00 Sq. Ft.  
No. 1762  
2 STORY MASONRY & BASEMENT**

**TAX LOT 18  
No. 1764  
2 STORY MASONRY & BASEMENT**

**TAX LOT 16  
No. 1760  
2 STORY MASONRY & BASEMENT**

**No. 1758  
2 STORY MASONRY & BASEMENT**

**No. 1766  
2 STORY MASONRY & BASEMENT**

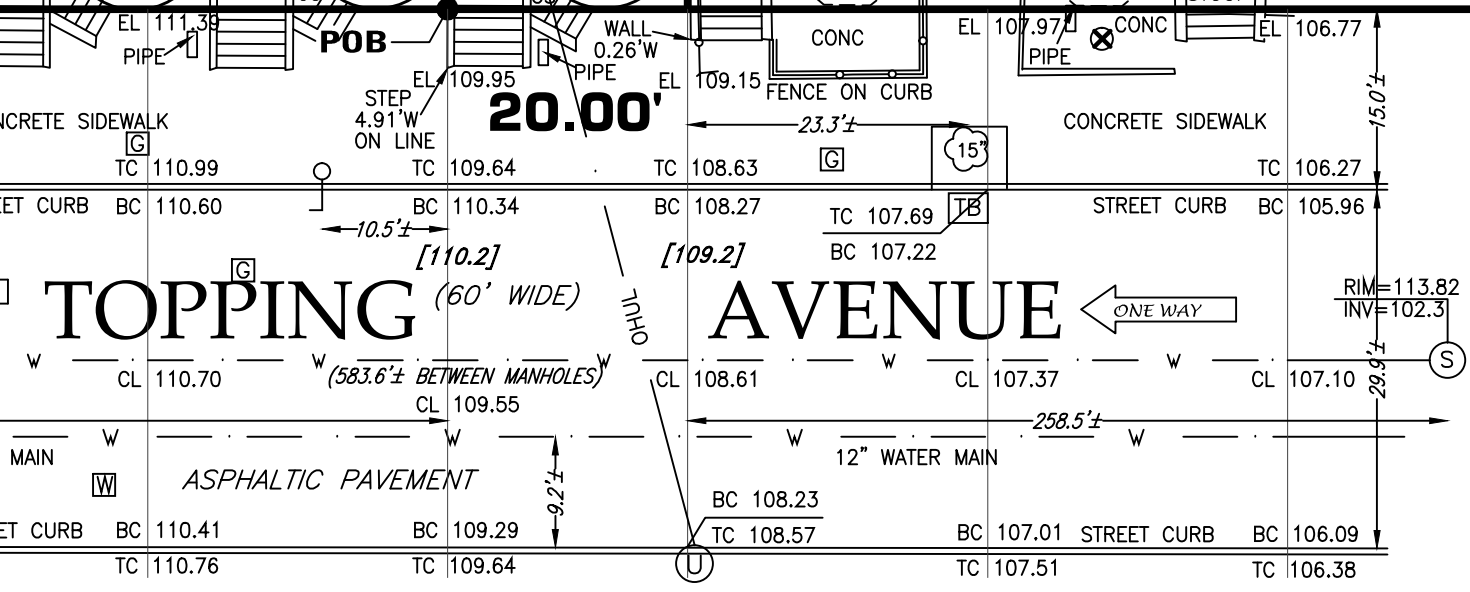

- GENERAL NOTES:**
1. CONSULT WITH THE HIGHWAY DEPARTMENT BEFORE DESIGNING, INSTALLING, OR MODIFYING ANY NEW OR EXISTING CURBS, WALKS, OR ROADWAYS IN THE STREETS SHOWN HEREON
  2. SUBSURFACE INFORMATION SHOWN HEREON WAS OBTAINED FROM VARIOUS CITY DEPARTMENTS AND/OR PRIVATE UTILITY COMPANIES WHERE ACCESSABLE. THIS SURVEYOR ACCEPTS NO RESPONSIBILITY FOR ANY OF THIS DATA. ADDITIONAL UNDERGROUND UTILITIES MAY EXIST WHICH ARE NOT SHOWN HEREON
  3. NEW YORK STATE LAW REQUIRES BEFORE EXCAVATE CALL 811, AND DIGNET AT 1-800-272-4480
  4. ELEVATIONS REFER TO THE NORTH AMERICAN VERTICAL DATUM OF 1988 (NAVD88). WHICH IS 1.51 FEET BELOW BRONX BOROUGH DATUM.
  5. THIS IS TO CERTIFY THAT THERE ARE NO VISIBLE STREAMS OR NATURAL WATER COURSES IN THE PROPERTY AS SHOWN ON THIS SURVEY.
  6. NONVISIBLE EASEMENTS, RECORDED OR UNRECORDED, NOT SHOWN HEREON.
  7. SECTIONS WERE TAKEN AT 25' INTERVALS. UNLESS OTHERWISE NOTED.
  8. LEGAL GRADE REFERS TO TOP OF CURB.
  9. UNDERGROUND STRUCTURES NOT LOCATED.
  10. THIS PROPERTY IS ON FLOOD INSURANCE RATE MAP PANEL 82 OF 457 IN COMMUNITY PANEL No. 360497 082F; LOCATED IN ZONE X (AREAS DETERMINED TO BE OUTSIDE THE 0.2% ANNUAL CHANCE FLOODPLAIN) MAP REVISED: SEPTEMBER 5, 2007
  11. VISUALLY THERE IS NO SEWER MANHOLE ALONG TOPPING AVENUE

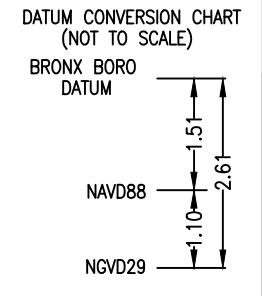
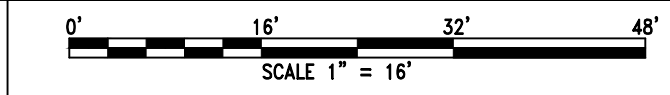

**LEGEND**

- [108.3] . . . . . LEGAL GRADE
- FF . . . . . FIRST FLOOR ELEVATION
- RP . . . . . ROOF PARAPET ELEVATION
- TC . . . . . TOP OF CURB
- BC . . . . . BOTTOM OF CURB
- CL . . . . . CENTERLINE
- EL . . . . . SPOT ELEVATION
- BW . . . . . BAY WINDOW
- CONC . . . . . CONCRETE
- CS . . . . . CELLAR STEPS
- OHUL . . . . . OVERHEAD UTILITY LINES
- [TB] . . . . . TELEPHONE BOOTH
- [W] . . . . . WATER VALVE
- [G] . . . . . GAS VALVE
- [U] . . . . . LIGHT POLE
- [6"] . . . . . UTILITY POLE
- [6"] . . . . . TREE & SIZE
- [X] DI . . . . . DRAIN INLET
- [X] . . . . . IRON FENCE
- [X-X] . . . . . CHAIN LINK FENCE
- [---] . . . . . PROPERTY LINE

Date of Survey: December 16, 2016

Tax Block: 2799  
Tax Lot: 17

**PROPERTY SITUATED AT**  
1762 Topping Avenue  
Borough & County of Bronx  
City & State of New York

Architectural Survey Ramzan Alli License No. 050457

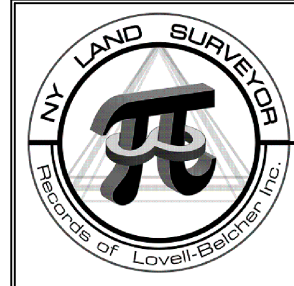

**NY Land Surveyor P.C.**  
Records of: Earl B. Lovell - S.P. Belcher Inc.  
77-15 164 Street, Fresh Meadows, NY 11366  
Tel: 718-591-6600 Tel: 212-732-1575  
nylandsurveyor@gmail.com Fax: 631-930-3292  
www.nylandsurveyor.com

UNAUTHORIZED ALTERATION OR ADDITION TO THIS SURVEY IS A VIOLATION OF SECTION 7209, OF THE NEW YORK STATE EDUCATIONAL LAW. COPIES OF THIS SURVEY NOT BEARING THE LAND SURVEYOR'S INKED SEAL OR EMBOSSED SEAL SHALL NOT BE CONSIDERED TO BE A VALID TRUE COPY. CERTIFICATIONS INDICATED HEREON SHALL RUN ONLY TO THE PERSON FOR WHOM THE SURVEY IS PREPARED AND ON HIS BEHALF TO THE TITLE COMPANY, GOVERNMENTAL AGENCY AND LENDING INSTITUTION LISTED HEREON, AND TO THE ASSIGNEES OF THE LENDING INSTITUTION. CERTIFICATIONS ARE NOT TRANSFERABLE TO ADDITIONAL INSTITUTIONS OR SUBSEQUENT OWNERS.